

You may photocopy this sheet and use it as an order form.



Model SL-6207-BA

Shifting Lever
NEW SHIMANO 600EX / Band A-Type

SL-6207-BB

Shifting Lever
NEW SHIMANO 600EX / Band B-Type

SL-6207-FA

Shifting Lever
NEW SHIMANO 600EX / Brazed-on A-Type

SL-6207-FB

Shifting Lever
NEW SHIMANO 600EX / Brazed-on B-Type

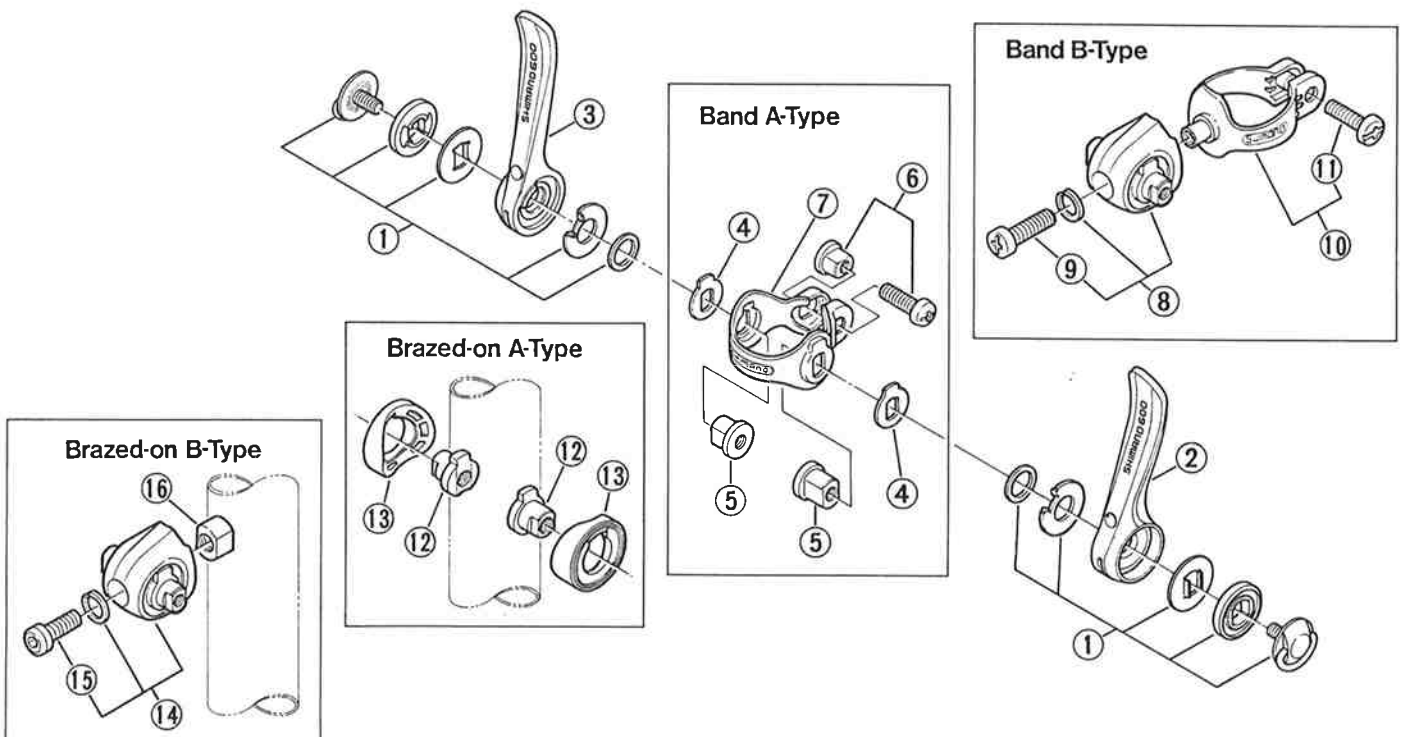

| ITEM NO. | PART NO. | DESCRIPTION | Q'TY |
|----------|------------|--|------|
| 1 | 3-640 9801 | Shifter Parts | |
| 2 | 3-640 9802 | Rear Lever | |
| 3 | 3-640 9803 | Front Lever | |
| 4 | 681 4100 | Washer A for Band A-Type | |
| 5 | 681 0800 | Lever Axle for Band A-Type | |
| * 6 | 3-681 9811 | Clamp Screw & Nut for Band A-Type | |
| * 7 | 681 3102 | Clamp Band for Band A-Type | |
| 8 | 3-640 9821 | Housing Unit for Band B-Type | |
| 9 | 690 0900 | Housing Fixing Screw for Band B-Type | |
| 10 | 3-640 9812 | Clamp Band Unit for Band B-Type | |
| 11 | 681 1600 | Clamp Screw for Band B-Type | |
| 12 | 681 4500 | Brazed-on Axle for A-Type | |
| 13 | 644 2001 | Brazed-on Axle Cover for A-Type | |
| 14 | 3-640 9822 | Housing Unit for Brazed-on B-Type | |
| 15 | 681 6400 | Housing Fixing Bolt for Brazed-on B-Type | |
| 16 | 681 6200 | Brazed-on Axle for B-Type | |

Printed in Japan 8310-U596"-1

発行 58.10.31